



RADISSON COLLECTION

RESORT NANJING

南京丽笙精选度假酒店



Welcome to  
an Exceptional stay



Every Moment Matters™  
每时每刻，弥足珍贵



Nanjing  
Attractions  
南京景点





Every Moment Matters™  
每时每刻，弥足珍贵

目的地	距离（千米）	打车（分钟）
Destination	Distance (km)	By Taxi (min)
南京禄口国际机场		
Nanjing Lukou International Airport	58	50
沪蓉高速		
Shanghai-Chengdu Expressway	4	10
南京站		
Nanjing Railway Station	30	30
南京南站		
Nanjing South Railway Station	35	40
栖霞山风景区		
Qixia Mountain Scenic Spot	15	25
南京万达茂商圈		
To Nanjing Wanda Mall	8	15
南京猿人洞风景区		
Tangshang Ape-man Caves	10	15

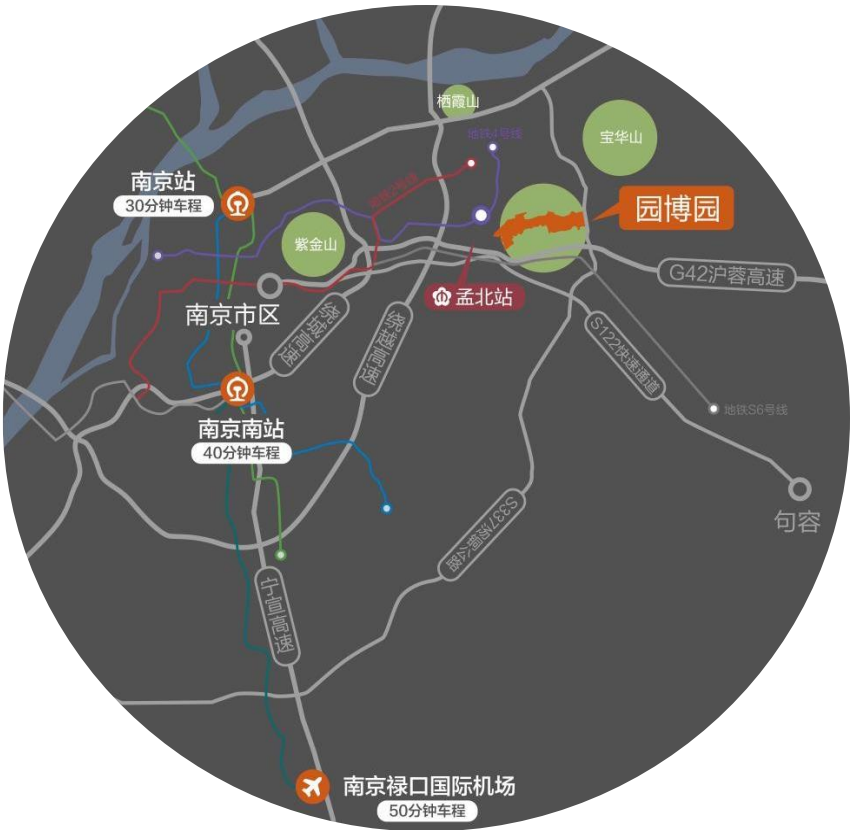

如何到达：

高速线路

G42沪蓉高速直达园博园，阳山互通口下，10分钟即达园博园4号门

南京市内交通

地铁4号线，孟北站





优越的地理位置  
Superb Location

Radisson Collection Resort, Nanjing, a chic and stylish new five-star retreat located within Jiangsu Horticultural Exposition Park, the spectacular integrated tourism complex.

Nestled on the banks of a lake and surrounded by floral gardens, hot springs and mountains, Radisson Collection Resort, Nanjing is inspired by the scenery of its destination.

南京丽笙精选度假酒店坐落于规模宏大的综合旅游景区——江苏园博园内，隐匿在一片静谧的园林中，松柏、温泉与青山环绕，酒店的建筑设  
计灵感也正来源于此。





## 优越的地理位置 Superb Location

The design concept appears to ripple and flow like water, and dramatic glass walls let light flood through the interiors, blurring the boundaries with nature and blending seamlessly with the surrounding environment.

酒店建筑如流水般清澈灵动，引人注目的玻璃幕墙让自然光线与风景涌入室内，模糊了建筑与自然的边界，让人感觉到无比惬意的自然返璞气息。为热爱自然并极富艺术鉴赏力的旅行者，以及极具品味的城中名流雅士打造一片隐匿于喧嚣闹市中的避世之所。





Radisson Collection Resort Nanjing is a masterpiece of design; a sleek, chic resort that embraces nature.

南京丽笙精选度假酒店是一件设计杰作，流光溢彩，优雅时髦，拥抱自然。



*Every Moment Matters™*  
每时每刻，弥足珍贵

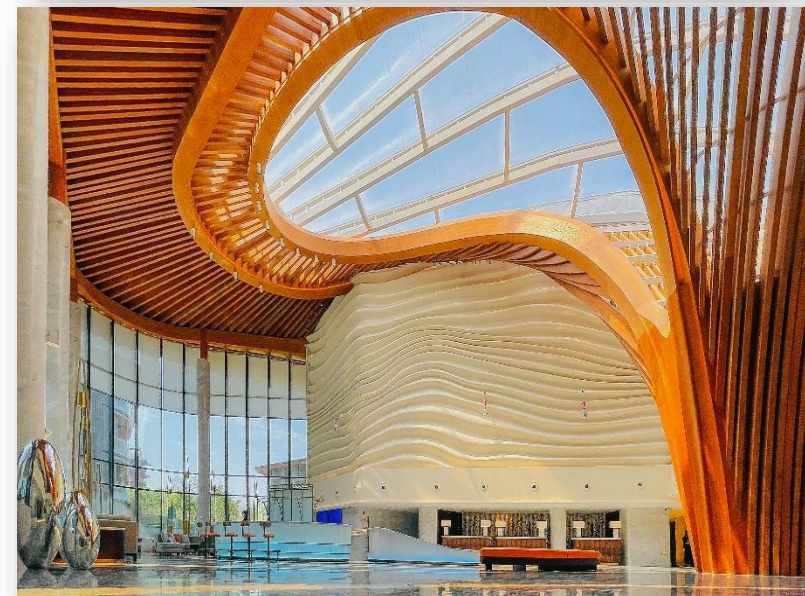
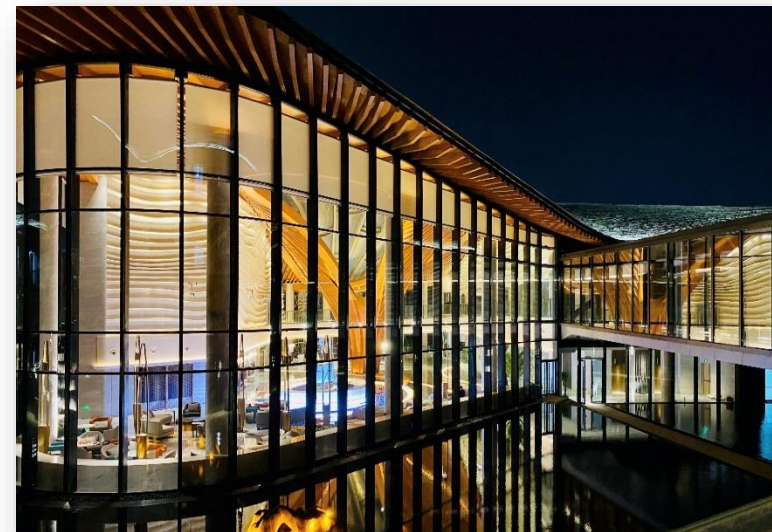

*Every Moment Matters™*  
每时每刻，弥足珍贵



# GUEST ROOMS AND SUITES





Every Moment Matters™  
每时每刻，弥足珍贵



房型  
Accommodation



房型 Room Type	面积 m <sup>2</sup>	数量 Number of Rooms	双床 Twin	大床 King
精选房 Collection Room	49	38	30	8
高级园景精选房 Collection Superior Garden Room-Garden View	49	57	35	22
豪华湖景精选房 Collection Deluxe Lakeview Room-Lake View	59	34	/	34
行政精选房 Collection Executive Room	49	13	5	8
豪华套房 Junior Suite	84	3	/	3
豪华园景套房 Deluxe Suite-Garden View	84	3	/	3
丽笙精选套房 Signature Suite-King Bed-Non Smoking	274	2	/	2
总统套房 Presidential Suite-King Bed-Non Smoking	336	1	/	1



*Every Moment Matters™*  
每时每刻，弥足珍贵



典雅住宿  
ELEGANT  
ACCOMMODATION



151间客房和套房以米白色为主调，深色木质地板与精心挑选的亚洲艺术品交错，呈献典雅舒适、格调时尚的宁静空间。  
Spaces that will delight your senses and inspire your vacation. Decorated in shades of cream, and accented by dark wood floor and a curated collection of Asian artworks, all of our 151 guest rooms and suites exude elegant comfort and style.



Every Moment Matters™  
每时每刻，弥足珍贵

典雅住宿  
ELEGANT  
ACCOMMODATION

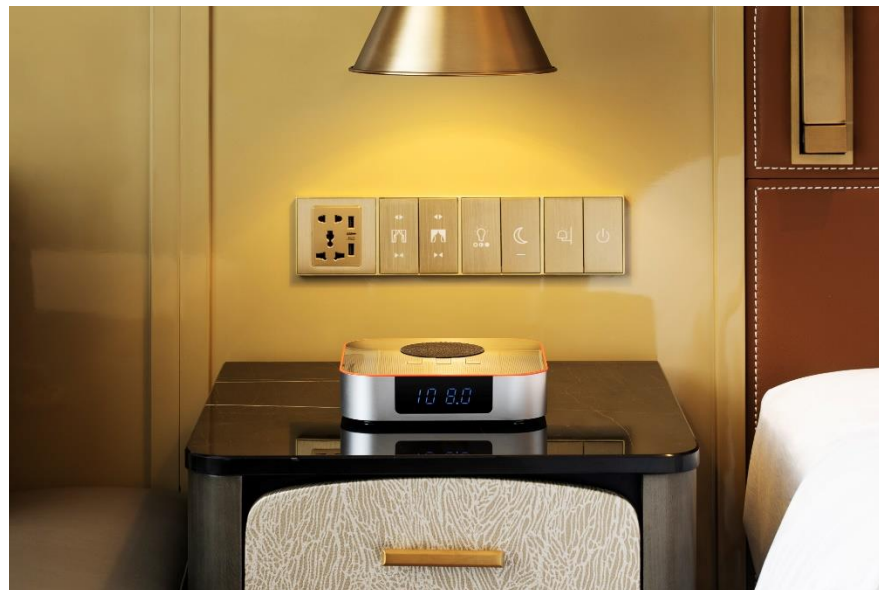

- 落地窗户及阳台把园博园四周的璀璨园景尽收眼底，启发无限度度假体验

Gaze over the spectacular surrounding garden view in the heart of the garden expo park

- 每间房间配备戴森电吹风

Dyson® hair dryer provided in all rooms

- 每间房间配备JBL蓝牙无线充电音响

JBL Bluetooth Speaker & Wireless Charger provided in all rooms



*Every Moment Matters™*  
每时每刻，弥足珍贵



# FOOD AND BEVERAGE





# 荟 · 全日餐厅

## Feast · All Day Dining



荟 · 全日餐厅  
Feast  
All Day Dining

一个现代和充满活力的空间，为您提供全天候餐饮服务，  
厨师在开放式厨房为您演绎精彩的烹调艺术  
A modern and vibrant space, providing live stations,  
pastry library and elegant buffets

环境优美、食材新鲜、品种繁多，色味俱佳  
Escapist, Visual, Authentic, Earthy

周一至周日  
MON-SUN  
早餐，午餐，晚餐  
Breakfast, Lunch,  
Dinner

总座位数：112  
Total seats: 112



*Every Moment Matters™*  
每时每刻，弥足珍贵

荟 · 全日餐厅  
Feast · All Day Dining





# 苏秀 · 中餐厅

## Suxiu · Chinese Restaurant



苏秀 · 中餐厅

Suxiu

Chinese Restaurant

在时尚环境中体验正宗淮扬经典美饌

A collection of authentic Huaiyang dishes  
presented in a modern setting

私密、传承、豪华、现代

Personal, Traditional, Luxurious, Modern

周一至周日

MON-SUN

午餐，晚餐

Lunch, Dinner

总座位数: 80, 包含  
5个独立包厢

Total seats: 80  
Seats, including 5  
private dining  
room



# 雅 · 大堂吧

## Elegance · Lobby Lounge



雅 · 大堂吧  
Elegance Lobby  
Lounge

传统英式下午茶，把源自欧洲的优雅传统带到亚洲，同样不容错过。

Modern and luxurious tea lounge, enjoy a taste of our European heritage, with our signature Afternoon Tea.

舒适、文化、典雅  
Comfort, Culture, Elegant

周一至周日  
MON-SUN  
下午茶  
Afternoon  
Tea

总座位数: 42  
Total seats: 42



*Every Moment Matters™*  
每时每刻，弥足珍贵



雅 · 大堂吧  
Elegance · Lobby Lounge





*Every Moment Matters™*  
每时每刻，弥足珍贵



# MEETINGS AND EVENTS





# 宴会厅 Ballroom



面积550平方米的无柱大宴会厅 - 蟠龙宴会厅，层高7米，嵌入式LED屏，可容纳250人参加圆桌会议或500人的剧院式会议。

The 7 meters height pillar-free grand ballroom - Panlong ballroom, measuring 550 sq. m with embedded LED screen, can accommodate up to 250 people in a roundtable setup or up to 500 people in a theatre setting.



# 多功能厅

## Function Room

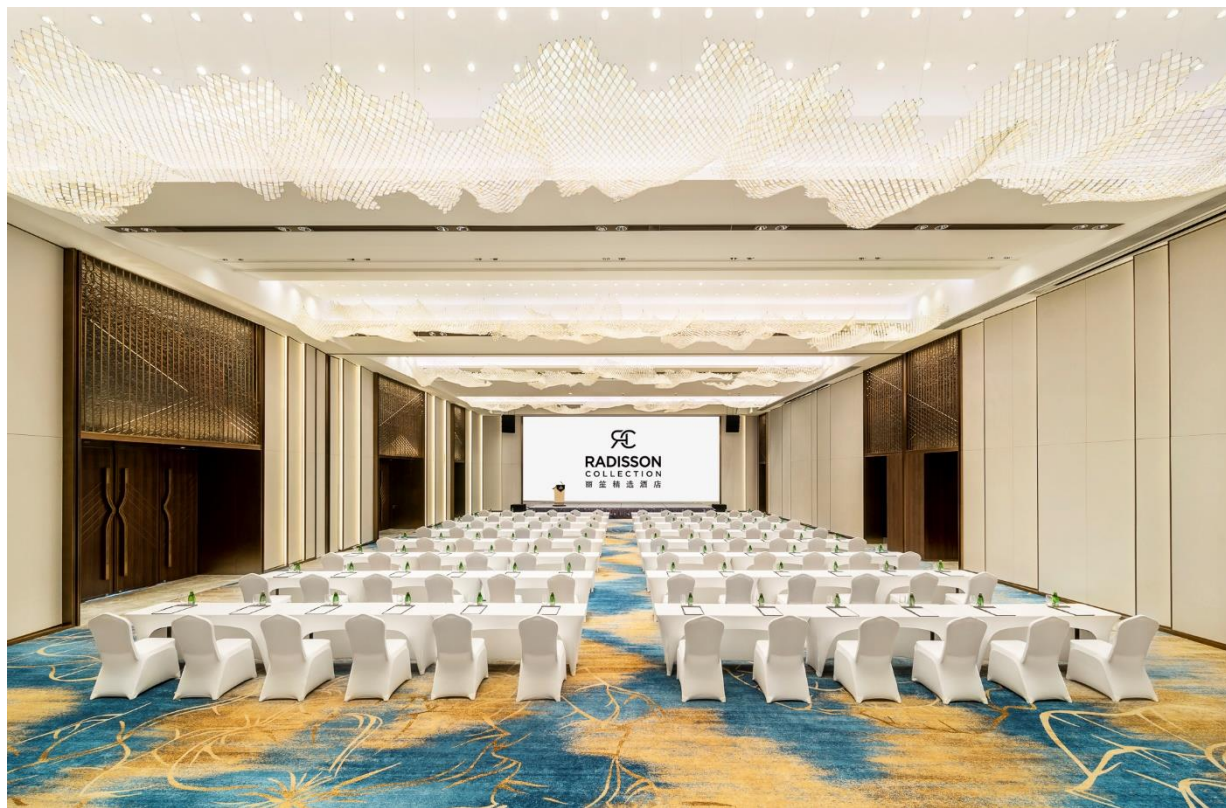

4间多功能厅，面积41平方米至124平方米不等，可满足不同会议的需求。

4 ancillary meeting rooms varying between 41sq.m to 124sq.m in size, can flexible to meet your needs.



# 可容纳人数

## Meeting Venue Matrix

场地	面积	长*宽*高	圆桌式	课桌式	鱼骨式	回型	剧院式	董事会
Venue	Area	L*W*H	Round table	Desk	Fishbone	Return	Theatre	Board of directors
蟠龙宴会厅	550	30*18.3*7	250	250	230	80	500	80
Panlong Ballroom								
蟠龙宴会厅1	275	18.3*15*7	120	120	110	40	250	40
Panlong Ballroom 1								
蟠龙宴会厅2	275	18.3*15*7	120	120	110	40	250	40
Panlong Ballroom 2								
宴会前厅	168	24*7*7	/	/	/	/	/	/
Foyer								
会议室1	41	6.8*6*3.5	40	24	24	18	40	14
Meeting Room 1								
会议室2	62	9.2*6.7*6	50	42	48	24	60	24
Meeting Room 2								
会议室3	62	9.2*6.7*6	50	42	48	24	60	24
Meeting Room 3								
会议室2+3	124	18.4*6.7*6	100	84	96	40	100	48
Meeting Room 2+3								
董事会议厅	51	8.5*6*3.4	/	/	/	/	/	16
Boardroom								



# 行政酒廊

## Executive Lounge





*Every Moment Matters™*  
每时每刻，弥足珍贵



# THE SPA AND FITNESS CENTRE



# 休闲娱乐 RECREATIONS



于绿茵环抱的园博园内，寻一处修养身心的避世之所，以焕然新生的护理开启回归本真的度假之旅。露天温泉泡池位于酒店二层，宾客可俯瞰园博园翠绿美景。

Amidst the stress of an occasionally overwhelming city, we have created a signature story of integrated, result-driven wellness within a chic sanctuary of revitalization. The outdoor hot spring is located on the 2nd floor, offering panoramic view overlooking the entire expo garden.



# 健身中心

## Fitness Centre

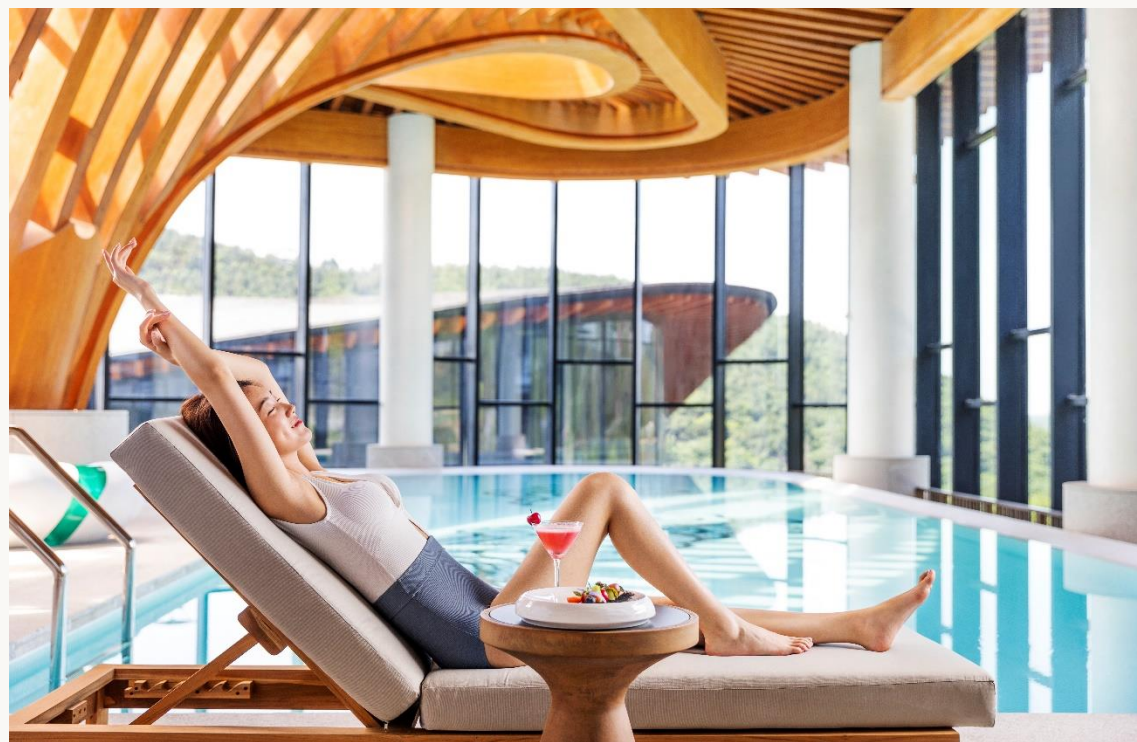
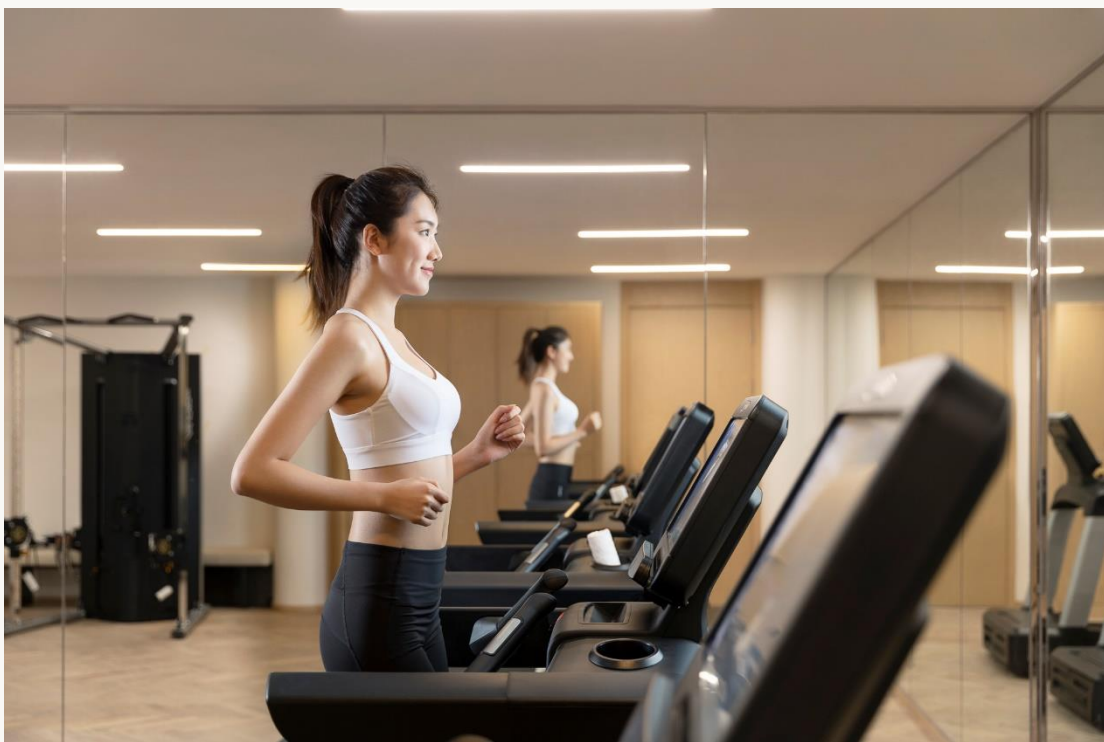

无边恒温室内游泳池位于酒店三层，同时可享设备先进的健身房、按摩浴池及泳池等设施。紧临窗边的设计，让客人畅泳的同时饱览室外如茵美景。

The infinite swimming pool is located on the 3rd floor, along with a state-of-the-art gym as well as wet areas, the close-to-the-window design ensures guests enjoy the beautiful view of Garden Expo Park during their swim.



RADISSON COLLECTION

RESORT NANJING

南京丽笙精选度假酒店

Welcome to the  
**EXCEPTIONAL**  
恣享非凡体验

中国南京市江宁区园博园路10号

No. 10 Yuanboyuan Road, Jiangning District, Nanjing, China, 211100

t +86 025-87159999 [info.rcrn@radissoncollection.com](mailto:info.rcrn@radissoncollection.com)

