



北京通州北投希尔顿酒店

Hilton Beijing Tongzhou

刘斌 Liu Bin

商务总监 Commercial Director

13901236284

bin.liu@Hilton.com



目录

Agenda

通州概况 Tongzhou General Situation	Page 3
酒店地理位置 Hotel Location	Page 4
酒店大堂 Hotel Lobby	Page 5
酒店客房 Hotel Guest Room	Page 6-8
酒店餐饮 Food & Beverage	Page 7-13
酒店宴会厅 Hotel Ballroom	Page 14-17
运河游会展奖励 Grand Canal Incentive	Page 18
中西式婚宴 Chinese & Western Wedding	Page 19
儿童活动区 Kids Area	Page 20
酒店设施 Hotel Facilities	Page 21
酒店周边的医院和学校 Hospitals and Schools Around Hotel	Page 22
酒店周边 Things To Do	Page 23-30

通州 – 北京城市副中心

Tongzhou – Sub City Center of Beijing

通州是京杭大运河的北起点、首都北京的东大门，距离首都国际机场30分钟车程。

金融服务行业、总部经济、高端制造业、文化及创业产业及电子商务行业将为通州的发展注入更多活力。2019年，北京市委市政府等市级机关入驻行政办公区并开始运行，它正式进入副中心时代。未来，这里将成为国际一流的和谐宜居之都示范区、新型城镇化示范区和京津冀区域协同发展示范区。

Tongzhou is located in east Beijing and considered the eastern gateway to the nation's capital. Thirty minutes to the Capital International Airport.

Such industrial development covers such domains as financial services, headquarter economy, high-end manufacturing, culture & creativity, logistics, and e-commerce. In 2019, the Beijing municipal government and other municipal authorities entered the administrative office area of Tongzhou and began to operate, it officially entered the sub-center era. In the future, there will become a world-class harmonious and livable district, a new type of urbanization district and a demonstration for coordinated development of Beijing-Tianjin-Hebei region.



酒店大堂

Hotel Lobby

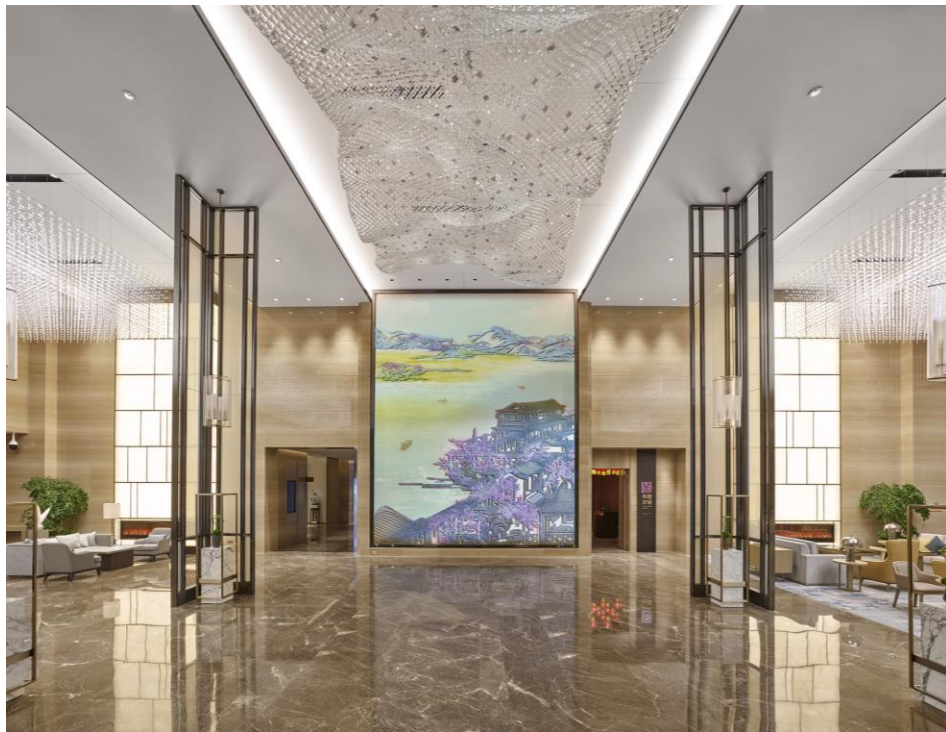

酒店大堂的投影壁画演绎着大运河的灿烂史诗，宾客可身临其境感受大运河的帆影连云、深沉睿智。

The projection mural in the lobby of the hotel shows the splendid epic of the Grand Canal, and guests can feel the integration of sails and the beautiful clouds beyond the Canal.



酒店客房

Hotel guest room

客房房型

Hotel Room Type

客房名称 Guest Room	面积 Area (m²)	房间总数量 Total Quantity	大床房 King Bed	双床房 Twin Bed	楼层 Floor
希尔顿客房 Guest Room	45	121	60	61	15F-21F
豪华客房 Guest Room Higher Floor	45	72	32	40	22F-26F
至尊豪华客房 Deluxe Room	60	31	31	-	15F-31F
行政客房 Executive Room	45	60	47	13	27F-31F
豪华套房 Deluxe Suite	90	25	25	-	15F-31F
大使套房 Ambassador Suite	150	1	1	-	3109
总统套房 Presidential Suite	210	1	1	-	3100
无障碍客房 Accessible Room	45	2	2	-	1620/1720
客房总数 Total number		313	199	114	

酒店客房

Hotel Guest Room



希尔顿客房

面积: 45平方米 数量: 121间
大床房: 60间 双床房: 61间
景色: 园林景观/河景

Guest Room

Area: 45m², Quantity rooms: 121,
King Bed Room 60, Twin Bed
Room 61
View: Park/River View



豪华套房

面积: 90平方米 数量: 25间
大床房: 25间
景色: 园林景观

Deluxe Suite

Area: 90m², Quantity: 25,
King Bed Room 25
View: Park View



至尊豪华客房

面积: 60平方米 数量: 31间
大床房: 31间
景观: 城市景观/园林景观

Deluxe Suite

Area: 60m², Quantity: 31,
King Bed Room 31
View: City/Park View



大使套房

面积: 150平方米 数量: 1间
大床房: 1间
景观: 城市景观/园林景观

Ambassador Suite

Area: 150m², Quantity: 1,
King Bed Room 1
View: City/Park View



酒店餐饮 Food & Beverage

大堂酒廊

Lobby Lounge



各式糕点、下午茶 & 咖啡、茶等饮品

在享用美味的同时感受乐队带来的美妙旋律，是小憩及小型商务会议的优选之地。

营业时间：09:30 - 23:00

乐队表演：19:00 - 23:00

座位数：40位

位置：酒店一层

Offering delicious handmade cakes, pastries and dessert, seasonal afternoon tea and coffee

The Lounge provides a primary space for break and mini meeting.

Operation Time: 09:30 – 23:00

Live Band Performance: 19:00 – 23:00

Seats: 40

Location: 1F

火锅餐厅 – 京巷

Hot Pot Restaurant – Jing Xiang



菜系: 特色火锅

精选时令食材，遵从久负盛名的传统方式精心制作，为宾客带来别样的地道美食体验。

主打特色锅底：花胶鸡汤 | 松茸菌锅

包厢: 1个 (4位) 午餐: 11:30 - 14:30

大厅: 18桌 (78位) 晚餐: 17:30 - 21:30

位置: 酒店一层

Signature: Specialty hotpot

Prepared elaborately with the long-reputed traditional techniques, special and authentic foods are served to the guests.

Flavor: Fish Maw | Matsutake

Private Room: 1 room (4 seats) Lunch 11:30 - 14:30

Great hall: 18 tables (78 guests) Dinner 17:30-21:30

Location: 1F

全日制餐厅 - 京味

ADD Restaurant – Jing Wei



用餐类型：国际自助餐、零点

开放式的厨房设计让宾客与主厨交流互动，丰富的中西式海陆自助为美食鉴赏家们提供了多元化的用餐选择。

早餐：6:30-10:30 (周一至周五) 午餐：11:30-14:30
6:30-11:00 (周六日及公共假期) 晚餐：17:30-22:00

座位数：136 位置：酒店二层

Dinning Types: International Buffet, A-la-cart

The open kitchen design enables the guests to interact with the chef. The rich Chinese and Western buffets provide gourmets with varied options.

Breakfast: 06:30 - 10:30 (Mon-Fri)
06:30 - 11:00 (Weekend & Public Holiday)

Lunch: 11:30 - 14:30
Dinner: 17:30 - 22:00

Seats: 136 Location: 2F

中餐厅 – 青雅

Chinese Restaurant – Qing Ya



菜系：京杭融合菜

餐厅主厨汲取京杭运河流域地方特色菜系的灵感，为宾客匠心奉上视觉与味觉完美融合的味蕾之旅。

座位数：170个
包厢：11间（124位）
大厅：14桌（46位）

营业时间
午餐：11:30 - 14:30
晚餐：17:30 - 21:30

位置：酒店四层

Signature: Beijing – Hangzhou Fusion Cuisines

Drawing inspiration from the local special cuisines of Beijing-Hangzhou Canal, the chef presents a wonderful journey of taste buds combining visual and palate enjoyment.

Seats: 170
Private room: 11 (124 seats)
Great hall: 14 tables (46 guests)

Operation Time
Lunch: 11:30 - 14:30
Dinner: 17:30 - 21:30

Location : 4F



酒店宴会厅 Hotel Ballroom

宴会厅容量

Conference and Event Rooms Capacity Chart

名称	总面积 (平方米)	长度 (米)	宽度 (米)	高度 (米)	教室式	剧场式	宴会式	鸡尾酒会	长方回型	U型	董事会型
大宴会厅	800	40	20	5.5	666	578	440	656	156	108	156
大宴会厅 1+2	560	28	20	5.5	252	326	280	326	75	52	75
大宴会厅 2+3	520	26	20	5.5	252	326	280	326	75	52	75
大宴会厅 1	280	14	20	5.5	156	260	130	200	66	39	60
大宴会厅 2	280	14	20	5.5	156	260	130	200	66	39	60
大宴会厅 3	240	12	20	5.5	150	171	120	180	60	36	66
大宴会前厅	460	46	10	3.15	-	-	200	280	-	-	-
多功能厅 1+2+3	423	28	15	3.5	186	280	180	286	90	78	90
多功能厅 1+2	273	18	15	3.5	117	186	130	180	60	51	60
多功能厅 2+3	294	19.6	15	3.5	117	186	130	180	60	51	60
多功能厅 1	129	8.6	15	3.5	67	88	60	90	30	24	30
多功能厅 2	144	9.6	15	3.5	70	96	60	98	30	27	30
多功能厅 3	150	10	15	3.5	70	96	60	98	30	27	30
会议室 1+2	144	15	9.6	3.5	78	108	60	140	54	36	54
会议室 1	77	8	9.6	3.5	39	58	50	70	27	18	27
会议室 2	77	8	9.6	3.5	39	58	50	70	27	18	27
会议室 3	67	7	9.6	3.5	39	48	50	70	27	18	27
通州厅	120	12	10	3.8	60	80	80	90	42	33	42
董事会会议室 1	40	7.7	5.2	2.8	-	-	-	-	-	-	12
董事会会议室 2	40	7.7	5.2	2.8	-	-	-	-	-	-	12
贵宾室	36	9	4	3.5	-	-	-	-	-	-	14

大宴会厅

Grand Ballroom

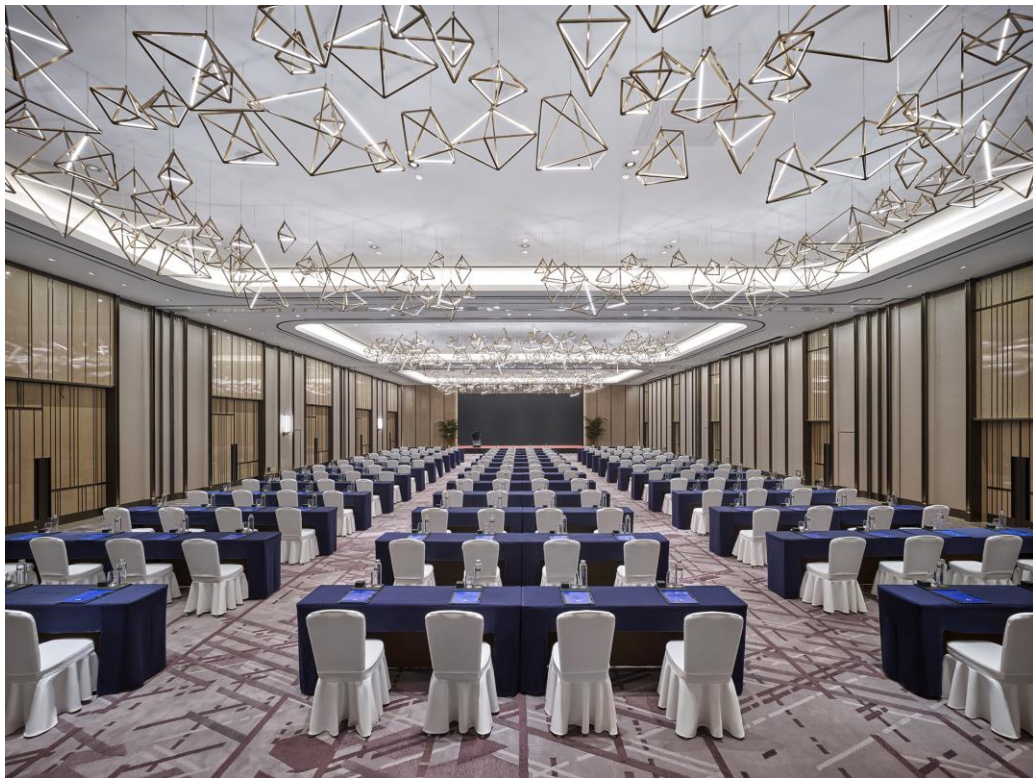

位于酒店M层的宴会厅庄重典雅，面积达800平方米，可以根据宾客需求分隔为3个独立空间。

多功能厅面积达423平方米，是商务宴会和社交活动的理想场所。

Grand Ballroom on the M floor of the hotel is solemn and elegant. With an area of 800m², it can be divided into three independent spaces according to the needs of guests.

Occupying 423 m², the multi-functional hall is an ideal site for business dinners and social activities.

宴会厅楼层分布

Ballroom

B1 层

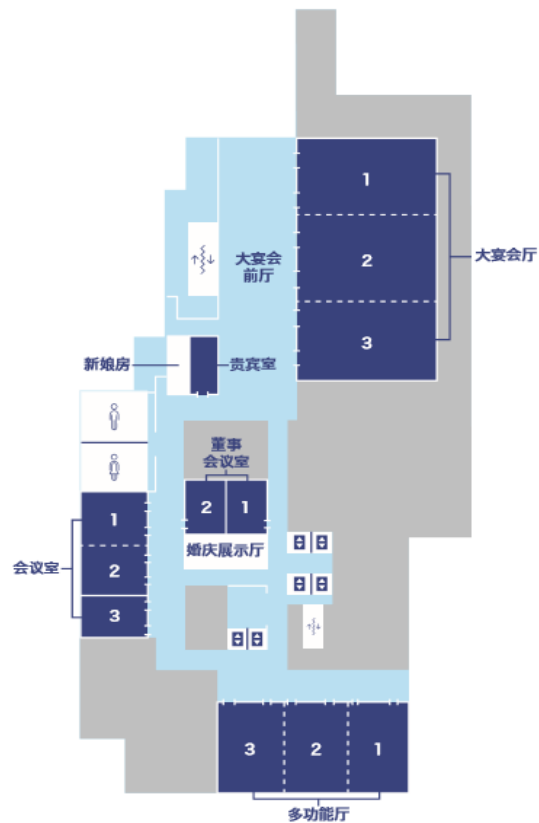

1 层

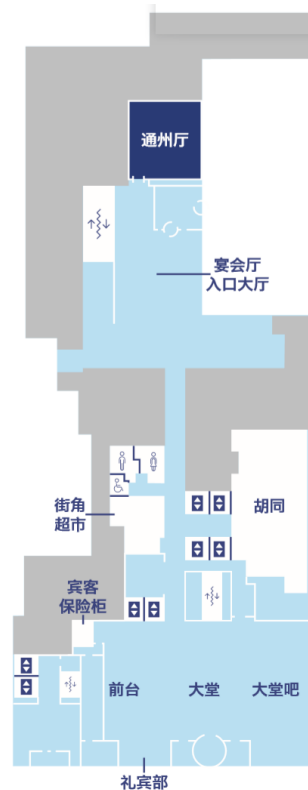

运河游·会展奖励

Grand Canal Conference Incentive Travel



永康号：可容纳40-50人



大业号游船：可容纳30人

古老的京杭运河见证了通州的发展，同时改变着人们的生活方式。

与团队成员一起乘坐皇家客船游览壮阔的千年运河，感受历史的脉络，专业的讲解员为团队详细讲解京杭大运河的故事。

The ancient Beijing-Hangzhou Grand Canal has witnessed the prosperity of Tongzhou and the changes of people's life. Experience the Grand Canal tour with team member and immersed in the historical moment.

游船期间，北京通州希尔顿酒店将为客人提供具有特色的北京及通州区域的传统小吃：咯咋盒、驴打滚、豌豆黄、艾窝窝等。大家品着北京传统茉莉花茶，观看北京特色京剧，享受着别样的会议体验。

While wandering on the ancient Grand Canal, tasting the snacks of Tongzhou, you will be offering the unforgettable canal experience.

中西式婚宴

Chinese & Western Wedding



时尚唯美的大宴会厅、精美的婚礼菜单以及无微不至的贴心服务，无论是举办传统的中式婚礼还是浪漫的西式婚礼，我们都将为您带来一段珍藏旅程。

The fashionable Grand Ballroom, exquisite wedding menu and personal service, whether you are planning an antique Chinese wedding or lavish western wedding, you will be starting an unforgettable and precious journey.

儿童活动区

Kids Area



设有儿童活动室，为儿童提供寓教于乐的活动空间。

Kids Room, providing a entertainment space with enjoyable and educational for children.

酒店设施

Hotel Facilities



宾客可以在健身房与室内恒温游泳池尽情享受畅泳的乐趣，锻炼体魄、重拾活力。

健身房：24小时

游泳池：6:00 - 22:00

楼层：3层

For a truly relaxing experience, go for swim in our constant temperature swimming pool and fitness center.

Fitness Center: 24hrs

Swimming Pool: 06:00 - 22:00

Location: 3F



酒店周边的医院与学校

Hospitals and Schools Around Hotel



探索北京 – 历史文化之旅

Tings To Do

京杭大运河是世界上最长最大的运河，始建于春秋晚期（770-476BC）。大运河南起杭州，北至北京通州，全长1797千米，沟通了海河、黄河、淮河、长江与钱塘江五大水系。

京杭大运河于2014年列入世界文化遗产名录，是中国的第46个世界遗产。

The Jinghang Grand Canal, the longest and biggest canal in the world, was first constructed in the late Spring and Autumn Period (770-476 BC). The canal starts in the south in Hangzhou in East China's Zhejiang Province and reaches to Beijing in the north, Spanning over 1,797 kilometers, it connects the waters of the Haihe River, Yellow River, Huaihe River, Yangtze River and Qiantang River.

It entered the World Heritage List in 2014 as the country's 46th world heritage item.



京杭大运河
Beijing – Hangzhou Grand Canal

探索北京 – 历史文化之旅

Tings To Do



长城

The Great Wall

长城是世界最伟大的奇迹之一，在1987年被列入联合国教科文组织世界遗产名录。从酒店乘车90分钟可到达。

The Great Wall is one of the greatest wonders of the world, was listed as a World Heritage by UNESCO in 1987.

90 minutes away by car



故宫

The Forbidden City

紫禁城也被称作是故宫博物院、故宫。位于北京的中轴线上，明朝的有24位皇帝曾在此居住。从酒店乘车29分钟可到达。

Forbidden City, also known as the Palace Museum, and Gu Gong in Chinese, lies at the city center of Beijing, and once served as the imperial palace for 24 emperors during the Ming and Qing Dynasties

29 minutes away by car



颐和园

Summer Palace

颐和园是清朝时期的皇家园林，主要由长寿山和昆明湖构成，占地2.9平方公里。从酒店驾车45分钟即可到达。

It was an imperial garden in the Qing dynasty. Mainly dominated by Longevity Hill and Kunming Lake, it covers an expanse of 2.9 square kilometres.

45 minutes away by car

探索北京 – 历史之旅

Tings To Do



天坛

Temple of Heaven

北京最大的宗教建筑，被认为是中国传统建筑中最伟大的杰作。从酒店发出乘车27分钟可到达。

The largest religious complex in the old outer city of Beijing, considered the supreme achievement of traditional Chinese architecture..

27 minutes away by car



南锣鼓巷

Nanluoguxiang

南锣鼓巷是北京最知名、最古老的一条胡同之一，有超过740年的历史。从酒店乘车30分钟可到达。

Nanluoguxiang is the most popular and one of the oldest Hutongs in Beijing with a history of more than 740 years.

30 minutes away by car



北海公园

Beihai Park

北海公园是京城中心年代最久远、占地面积最大，保存最为完整的皇家园林。从酒店乘车32分钟即可到达。

Beihai Park is one of the oldest, largest and best-preserved ancient imperial gardens in China located in center of Beijing.

32 minutes away by car

探索通州 – 文化休闲之旅

Tings To Do



大运河森林公园

Grand Canal Forest Park

大运河森林公园是人们休闲放松、户外野营、文化娱乐的理想场所，也是通州的一所运河生态天然大氧吧。从酒店发出乘车20分钟可到达。

Grand Canal Forest Park is the ideal place where people can camping, entertainment and relaxation. It is also know as the Oxygen bar of Tongzhou.

20 minutes away by car



韩美林艺术馆

Han Meilin Art Museum

馆内收藏实力派画家-韩美林先生的绘画、书法、雕塑、民间工艺等作品。从酒店乘车14分钟可到达。

The Art museum was named by Han Meilin. Collecting painting, calligraphy, Sculpture and folk arts etc.

14 minutes away by car



燃灯塔

Buddhist Relics Tower

燃灯塔是京杭大运河北端之胜景，亦是通州古城之象征。从酒店步行10分钟即可到达。

Lamp Tower is located in the north of Grand Canal, it is the symbol of Tongzhou.

10 minutes away on foot

探索通州 – 文化休闲之旅

Tings To Do



通州博物馆

Tongzhou Museum

通州博物馆建于1992年，通过114件古老的物件展示了通州自西汉至清朝的一段历史。从酒店出发步行10分钟可到达。

Tongzhou Museum was founded in 1992, displaying the history from Western Han to Qing Dynasty. "Ancient Tongzhou" is composed of 114 representative cultural relics.

10 minutes away by car



宋庄美术馆

Songzhuang Art Gallery

宋庄美术馆是艺术创意、作品展览及艺术学术类的交流区。从酒店出发乘车19分钟可到达。

Songzhuang Art Gallery is an art communication platform of the creation, exhibition and academy for artists.

19 minutes away by car



西海子公园

Xihaizi Park

公园最早建成于1936年，青山绿水相依，文物古迹互衬，公园环境优美，空气清新。从酒店出发步行8分钟可到达。

The Park was established in 1936, with beautiful scenery and fresh air, it has become the popular leisure space in Tongzhou district.

8 minutes away on foot

环球影城

Universal Beijing Resort



北京环球影城的各个景区将为宾客栩栩如生地呈现深受欢迎的电影故事和角色，并配有崭新的游乐设施、娱乐表演、特色商店和餐饮体验。

七大景区分别为功夫熊猫盖世之地、变形金刚基地、小黄人乐园、哈利波特的魔法世界、侏罗纪世界努布拉岛、好莱坞和未来水世界。

- 从酒店出发乘车30分钟即可到达
- 预计2021年7月开业

The seven highly themed and expansive lands at Universal Studios Beijing theme park will bring popular culture's most compelling stories and characters to life. Each land will contain a magnificently themed mix of attractions, shows, shops and restaurants.

They include: Kung Fu Panda Land of Awesomeness, Transformers: Metrobase, Minion Land, The Wizarding World of Harry Potter, Jurassic World Isla Nublar, Hollywood and WaterWorld.

- Grand Opening: Jul, 2021
- 30 minutes away by car

探索酒店周边 - 购物中心

Tings To Do



爱琴海购物中心 - 集大型购物广场、精装住宅、五星酒店和甲级写字楼为一体大型地标城市综合体。从酒店出发步行1分钟即可到达。

Aegean Shopping Mall – Complex building integrates shopping center, residents and five star hotel.
One minutes away by car.



万达购物广场 - 含万达百货、万达影城、大歌星KTV、万达宝贝王乐园、超市六大主力店，次主力店ZARA，以及200余个国内外服装、精品、体验和餐饮品牌。从酒店至万达广场乘车5分钟即可到达。

Wan Da Shopping mall including Wan da boutiques, cinema, KTV, baby club, supermarket, ZARA and more than 200 brands from home and abroad. Five minutes away by car.



翎展购物广场 - 涵盖餐饮、购物、娱乐、教育为一体的综合性购物中心。从酒店至翎展购物广场乘车10分钟即可到达。

Tongzhou Roosevelt shopping mall-integrates catering, shopping, recreation, entertainment and education with a gross floor area of 67,000 square meters. Ten minutes away by car.

