



WANDA REALM

Anyang

安阳富力万达嘉华酒店

安阳富力万达嘉华酒店

Wanda Realm Anyang

知所需 心安为嘉

A Reward You Deserve

2021/08/27

目录

Content

- **安阳简介**
Anyang Profile
- **机场信息**
Airport Information
- **火车站信息**
Train Information
- **安阳旅游景点**
Anyang City Tourist Attractions
- **酒店周边**
Hotel Peripheral
- **安阳特产**
Anyang Specialty
- **安阳万达嘉华酒店介绍**
Wanda Realm Anyang Profile

中国八大古都之一 – 安阳

Anyang – Ancient Capital



安阳是中国的八大古都之一、中国历史文化名城、甲骨文的故乡，周易的发源地。被考证为华夏文明最早使用文字甲骨文的地方，也是世界上最大的青铜器司母戊大方鼎的出土的地方。

Anyang is the most famous ancient capital in China and it played an important role in Chinese history. Anyang is the first place to use Jia Gu Wen in China, and the biggest bronze ware all over the world to be excavated here.

国家历史文化名城

中国八大古都

全国绿化模范城市

中国书法名城

2008中国魅力中小城市

中国文化旅游名城

中国航空运动之都

文字之都



机场信息

Airport Information



郑州新郑国际机场

郑州新郑国际机场（Zhengzhou Xinzheng International Airport）（ICAO机场代码：ZHCC；IATA机场代码：CGO），简称“新郑机场”，别称“轩辕机场”，于1997年8月28日建成通航。是中部地区首个拥有双航站楼、双跑道的机场，华中地区级别最高的飞机检修基地，是实现高速公路、地铁、高铁等多种交通方式无缝衔接的综合交通换乘中心。郑州新郑国际机场是中国八大区域性枢纽机场之一、中国四大货运机场之一，货邮运增幅全球最快（中国第一，中西部首位）。

距离酒店200km，大约2.5小时车程。



邯郸机场

邯郸马头机场（ICAO：ZBHD；IATA：HDG）是河北省邯郸市的一个民用机场，位于邯郸市西南11公里邯山区马头镇。机场占地两千余亩，按照4D级机场标准建设，可起降波音737系列和空客A319、A320等客机。

距离酒店60km，大约50分钟车程。

火车站信息

Train Information



安阳火车站

安阳站，原名彰德府站，位于河南省安阳市[北关区](#)解放路西段，始建于1905年（清光绪31年），是[京广铁路](#)的一个车站，北距北京站512公里，南离广州站1792公里，隶属郑州铁路局安阳车务段管辖，现为[一等站](#)。日均客运量达2.3万余人，接发客车43对，北可达北京，南可至郑州、武汉、广州。[安阳站](#)紧靠[公交车站](#)和安阳[长途汽车站](#)（距离约为50米），旅客们在10分钟之内[步行](#)可实现普铁、动车、高铁、长途汽车与公交车、出租车的无缝换乘。

距离酒店6km，大约15分钟车程。



安阳东站（高铁站）

安阳东站，即[京广铁路客运专线](#)安阳东火车站（[石武高铁](#)安阳东站），位于[京港澳高速公路](#)安阳段东侧2公里处，站中心里程为CK501+200。车站性质定位为[中间站](#)，是[河南省](#)最北面的车站，也是[郑州铁路局](#)最北面的站，有河南的北大门之称。

距离酒店7km，大约20分钟车程。

租车价目表

Transportation Price List



安阳富力万达嘉华酒店豪车服务价格表（人民币）
Wanda Realm Anyang Limousine Service Price Form(RMB)

	接站送站/接机送机 Pick Up/Send Off				安阳市区包车 City Center		安阳周边包车 City Vicinity	河南全天包车 Henan Province Inside
	安阳火车站 Anyang Train Station	安阳东站 Anyang East Station	邯郸机场 Han Dan Airport	新郑机场 Xin Zheng Airport	半天 (4h) Half Day	全天(8h) Full Day	全天(8h) Full Day	全天(8h) Full Day
奥迪 A6L Audi A6L	120	120	800	2,000	650	1,100	1,300	2,500
奔驰 E320 BENZ E320	140	140	900	2,100	750	1,300	1,500	2,600
金杯 Jin Bei	140	140	1,000	2,200	650	1,100	1,400	2,700
奔驰商务 BENZ Viano	160	160	1,200	2,500	950	1,600	1,800	3,000
考斯特 Coaster	240	240	2,000	3,200	1,650	2,300	2,400	3,800

备注 Remarks:

1、过路费（桥梁、公路等），停车费由客人承担。

The road toll(including high speed way & brigde passing toll) , parking charge will be charged from the guest.

2、等候半小时以内免费，超时收费标准：小轿车50元/小时，奔驰商务100元/小时，考斯特200元/小时。

It is free to wait in half an hour,if the guest extends waiting time,the charge standard is:BENZ E320&Audi A6L 50RMB/hour, Business Car 100RMB/hour,Coster 200RMB/hour.

3、包车半天(4h)100km以内，全天(8h)200km以内。超时：小轿车50元/小时，奔驰商务车100元/小时，考斯特200元/小时；超出公里：小轿车3元/公里，奔驰商务6元/公里，考斯特8元/公里。

The maximal distance of half day renting is 100km,the full day renting limited distance is 200km,if more distance the guest need ,we need to charge: BENZ E320&Audi A6L 50RMB/hour, Business Car 100RMB/hour, Coaster 200RMB/hour; Overtime miles: BENZ E320&Audi A6L 3RMB/km,Business Car 6RMB/km,Coster 8RMB/km.

4、如遇燃油价格浮动，本价格表可能有所调整，恕不另行通知。

If there is oil adjusting,the price may charge,without extra oil fluctuate,this price form maybe adjusted,without extra informing.

5、请提前一天预订车辆。

Please make reservation in advance.

6、以上价格均已包含增值税

Above prices are including value add TAX

安阳旅游景点

Anyang City Tourist Attractions



中国文字博物馆

中国文字博物馆，是一座集文物保护、陈列展示和科学研究功能为一体的国家级、专题博物馆，也是中国第一座以文字为主题的博物馆。

National Museum of Chinese Writing, is a collection of cultural relics protection, display and scientific research function for the integration of national and thematic museum, is also China's first with words as the theme of the museum.

距离酒店4km，大约10分钟车程。



殷墟

殷墟是被证实的中国历史上第一个都城。在王陵东边出土的司母戊大方鼎是目前世界上最大的青铜器。殷墟的发现被评为20世纪中国“100项重大考古发现”之首，殷墟的发现代表了中国古代早起王陵的建设最高水平。

Yin Xu is the first capital in China. The biggest bronze ware all over the world was been found in Yin Xu.

距离酒店10km，大约25分钟车程。



岳飞庙

岳飞庙坐落于安阳的汤阴。岳飞庙的建立主要是为了纪念岳飞这位抗金英雄，并且赞扬岳飞的忠孝而建立的。

Yuefei Temple is located in Tangyin Anyang. To build up the temple is not only for his spirit of patriotism and love for his country.

距离酒店25km，大约30分钟车程。

安阳旅游景点

Anyang City Tourist Attractions



羑里城

羑里城遗址，第四批全国重点文物保护单位，新石器时代、商、周遗址。位于河南省安阳市汤阴县城北约4公里处的羑(yǒu)里城，是世界遗存最早的国家监狱，也是风靡全球的周易文化发祥地。它以博大精深的文化内涵而名扬海内外，“划地为牢”、“文王拘而演周易”历史典故均源于此。

You city site, the fourth batch of national key cultural relics protection units, Neolithic, the ruins of the Shang and Zhou. Located about 4 km north Tangyin County, Anyang City, Henan Province. Department of you in the city of Heliopolis, the world remains the earliest state prison, but also swept the world of Zhouyi culture birthplace.

距离酒店20km，大约25分钟车程。



马氏庄园

马氏庄园位于河南省安阳市西部20公里的西蒋村，是清代广东巡抚马丕瑤的府第，建于清光绪至民国初期，保存完好，占地面积20000多平方米，其中建筑面积5000多平方米，被学者称为“中州大地绝无仅有的封建官僚府第建筑标本”，“中原第一官宅”，是全国重点文物保护单位，国家AAAA级旅游景区，全国红色旅游经典景区，河南省廉政教育基地。

Mashi manor is located 20 kilometers west of Anyang City of Henan Province, West Jiang Cun is in Guangdong during the Qing Dynasty governor Ma Piyao mansion, built in the Qing Guangxu period of the Qing Dynasty to the early Republic of China, the well preserved, covers an area of more than 20000 square meters, which construction area of 5000 square meters, scholars have referred to as the "Central Plains earth unique feudal bureaucrat mansion building specimens", "Central Plains of the first official residence", is a national key cultural relics protection units, the national AAAA level scenic spots, national classic red tourism scenic spot, Henan Province independent education base.

距离酒店30km，大约50分钟车程。



安阳旅游景点

Anyang City Tourist Attractions



红旗渠

红旗渠是20世纪60年代，从太行山腰修建的引漳入林工程，被人称为“人工天河”。

Hong Qi Ou was been built in 1960s, from Tang Hang Mountain.

距离酒店80km，大约1.5小时车程。



太行大峡谷

太行大峡谷地处河南省西北部，海拔800—1739米，相对高差达1000米以上，境内断崖高起，群峰峥嵘，阳刚劲露，台壁交错，苍溪水湍，流瀑四挂姿态万千，是“北雄风光”的典型代表，号称“太行大峡谷”。

Taihang Grand Canyon is located in the northwest of Henan Province, an elevation of 800 – 1739 meters, the relative elevation of 1000 meters above, high territory cliff, towering peaks, masculine Jin Lu, staggered wall units, Cangxi water turbulent flow four waterfall hanging, thousands of attitude is the typical representative of beixiong scenery, known as the "Taihang Grand Canyon".

距离酒店85km，大约2小时车程。

酒店周边

Hotel peripheral



安阳万达广场

安阳万达广场位于中华路南段，地处安东新区核心位置，地理位置优越，交通便利。包括有万达百货、万达影院、大歌星KTV、电玩、大型生活超市、电器超市等6大主力店和众多国内国际潮流品牌，融汇购物、餐饮、休闲、娱乐多功能体验，全方位满足“吃、喝、玩、乐、游、购、娱”一站式都市生活新标准！

Anyang Wanda Plaza is located in the southern section, located in Andong District core position, location and convenient transportation. Including Wanda Department, Wanda cinema, big star KTV, gaming, large supermarkets, electrical appliances supermarket 6 large anchor stores and numerous domestic and international fashion brands, the blend of shopping, dining, leisure, entertainment experience, a full range to meet "eat, drink, play, music, travel, shopping, entertainment," the station of urban life new standard!

距离酒店200m。

酒店周边
Hotel peripheral



安阳义乌国际商贸城

安阳义乌商贸城以大型批发市场及超市、百货和主题休闲街区、家居广场、数码广场、家电广场、美食广场、娱乐广场、电影院线等多种商业业态组成。

Anyang Yiwu International Trade City in a large-scale wholesale markets and supermarkets, department stores and theme leisure Street, home Plaza, Digital Plaza, home appliance square, the food plaza, entertainment plaza, cinemas, etc. a variety of commercial formats.

距离酒店150m。



酒店周边

Hotel peripheral



永辉超市

位于安阳万达广场B1层，总面积9000多平方米。主营生鲜、加工食品、日常用品、家居、家用电器、电子产品和进口商品，有3万多种单品，可满足您的生活购物需求。

Anyang Wanda Plaza B1 floor, with a total area of more than 9000 square meters. Main fresh, processed food, daily necessities, household appliances, household appliances, electronic products and imported goods, there are more than 30 thousand kinds of single product, can meet your needs.

距离酒店200m。



丹尼斯百货

丹尼斯百货是一家集购物、休闲为一体的生活广场，它地处安阳市中华路南段，义乌国际商贸城南侧。共分两层：一层经营名店百货，；二层经营大型量贩超市，2万多种以上商品可供顾客选择。

Dennis department store is a set of shopping, leisure as one's Life Plaza. It located in Anyang City Zhonghua Road South, Yiwu International Trade City on the south side. A total of two layers: a layer of business boutique department store, large supermarket management; two, more than 20 thousand kinds of goods are available.

距离酒店200m。

安阳特产

Anyang Specialty



道口烧鸡

Red-Cooked Chicken, Daokou Style



郑家粉皮

Zheng Jia vermicelli



水冶关家酥烧饼

Shuiye Kwan crisp Clay oven rolls



老庙牛肉

Old temple



内黄大枣

Neihuang jujube

酒店概要

Hotel Summary



安阳富力万达嘉华酒店地处安阳核心区域，毗邻安阳万达广场，地理位置十分优越。酒店距离安阳高铁站仅15分钟车程，前往河北邯郸机场亦只需50分钟车程，交通极为便利。酒店拥有282间客房与套房，设计时尚而雅致；多家特色餐饮提供选择丰富的精致美食；设备齐全的健身中心，助宾客缓解日间疲劳。酒店内设有大宴会厅及多功能厅，提供灵活多变的组合方式，配合专业的服务团队，是举办浪漫婚宴、各式会议的不二之选。舒适如置身云端的“万达嘉华之床”及“妙梦”助眠系列、独立浴缸与热带雨林式淋浴设施，为您营造舒适惬意的居停感受。

Superbly situated in the city's dynamic Central Business District, adjacent to Wanda Plaza, the hotel is within walking distance of the top leisure and entertainment venues. Wanda Realm Anyang is just a 15-minute drive from the Anyang high-speed railway station and only 50 minutes from Hebei Handan Airport. The hotel comprises 282 rooms and suites all with a stylish decor of contemporary elegance. Several different kinds restaurants all provide world-class cuisine. Well equipped health club relax every guest. The hotel also boasts well-appointed meeting and events venues, with dividable spaces, combining professional meeting directors team, being the best choice of romantic wedding and different scaled meetings. Wanda Realm's signature services, including the Realm Angel reception and Dream Catcher services will further enhance your unforgettable experience at Wanda Realm Anyang.

餐饮设施

Food & Beverage



“美食汇”西餐厅为您贴心准备方便美味的“外带早餐”，让您在高效工作之余感受温暖关怀；汇聚各国佳肴的自助大餐以及别有情调的招牌零点，更是让您的午间聚会和晚间盛宴惊喜不断！

Café Realm let our hotel guests enjoy the sumptuous breakfast and dinner buffets ,also western a la carte menu is available . At Wanda we Have the convenience and delicious “Takeaway Breakfast” All in all, you're get pampered with delicious surprises at Café Realm, day or night.

营业时间 Time: 06:30-10:00 17:30-21:30

预订电话 Tel: 0372-377 9999



餐饮设施

Food & Beverage



“品珍”中餐厅以本地特色菜、粤菜以及点心为主，专注于原汁原味以及均衡营养。美食佳酿的精致感受、匠心独具的奢华氛围以及温情倍至的周到服务，令您忘返于独具东方特色的美食文化。

Zhen Chinese Restaurant specializes in local specialties, Cantonese and Dim Sum. While presenting colorful dishes in their authentic flavor, special attention is paid to offer balanced nutrition. Take delight in the Oriental culinary tradition that combines superb wine and dine, regal dining ambience and impeccable service.

营业时间 Time: 11:30-14:00 17:30-22:00

预订电话 Tel: 0372-377 9999



餐饮设施

Food & Beverage



营业时间 Time: 10:00-23:00

预订电话 Tel: 0372-377 9999

大堂酒廊提供精致咖啡茶点、啤酒、特色鸡尾酒以及精选红酒及香槟，佐以精美小点，打造舒适惬意的会见空间，是与友人聚会、商务会谈的理想场所。专业的乐队让您在优美动听的歌曲中尽享悠然惬意的时光。

The Lobby Lounge offers a wide selection of coffee, tea, beers, cocktails, wine, champagne and snacks in an elegant and comfortable ambience. It is the perfect setting for a private meeting, whether it's a casual social gathering or important business discussion. Professional band in sounds beautiful songs for you enjoy the carefree and comfortable time.

LOBBY LOUNGE
大堂酒廊

酒店客房

Guest Rooms



安阳富力万达嘉华酒店拥有282间客房与套房，设计时尚而雅致。每间客房均配备温馨舒适：“万达嘉华之床”及“妙梦”助眠系列可供选择，为所有商务及休闲宾客缔造温馨惬意的居停感受。

The hotel is comprised of 282 rooms and suites all with a stylish decor of contemporary elegance. To ensure a comfortable stay for both business and leisure travelers, every room features a “Bed of Realm” and “Dream Catcher.”

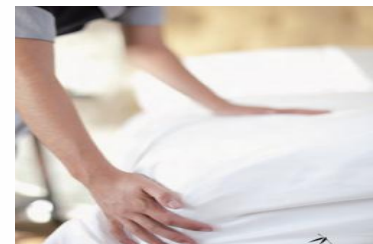

客房介绍

Guest Rooms

房型: Room Type	数量: No.	面积: Sqm
豪华大床房 Deluxe King Room	27	32
豪华双床房 Deluxe Twin Room	98	32
高级豪华大床房: Grand King Room	53	32
高级豪华双床房: Grand Deluxe Twin Room	31	32
行政楼层大床房: Executive King Room	44	32
行政楼层双床房: Executive Twin Room	15	32
无障碍套房: Handicapped Deluxe King	2	32
行政套房: Executive Suite	10	60
董事套房: Chairman Suite	1	108
总统套房: President Suite	1	270



董事套房 Chairman Suite

客房设施

Guest Room Features & Amenities



- “万达嘉华之床”及“妙梦”助眠系列
“Bed of Realm” & “Dream Cather”
- 免费高速上网设施
Complimentary high-speed Internet access
- 拥有国际卫星频道的平面液晶电视
LED TV with international satellite channels
- 数码保险箱
Digital safe
- 独立浴缸与热带雨林式淋浴设施
Separate bath and rainforest shower
- 迷你酒吧及咖啡/茶冲煮设备
Minibar and coffee/tea making facilities
- 提供洗衣服务
Offering laundry service



会议与宴会

Meeting and Banquet



超2,000平方米的宴会及会议空间，包括大宴会厅及3个多功能会议厅，可根据宾客需求灵活组合分隔，全部配备先进的视听及多媒体设备，另有VIP接见室可供私密会谈专用。酒店配备经验丰富的专业接待团队，以高端齐全的会议设施、豪华舒适的环境为宾客打造满意的会议及活动体验。

Hotel offers more than 2,000 sqms of total conference space which can be divided flexibly, including a plush Grand Ballroom and three sophisticated meeting venues, all equipped with state-of-the-art audio visual and multimedia facilities, with one VIP meeting room designed for private uses, exclusive meeting directors, enabling you to create the perfect ambience for your unique needs.



三层平面图

3F Floor Plan

三层
Level 3

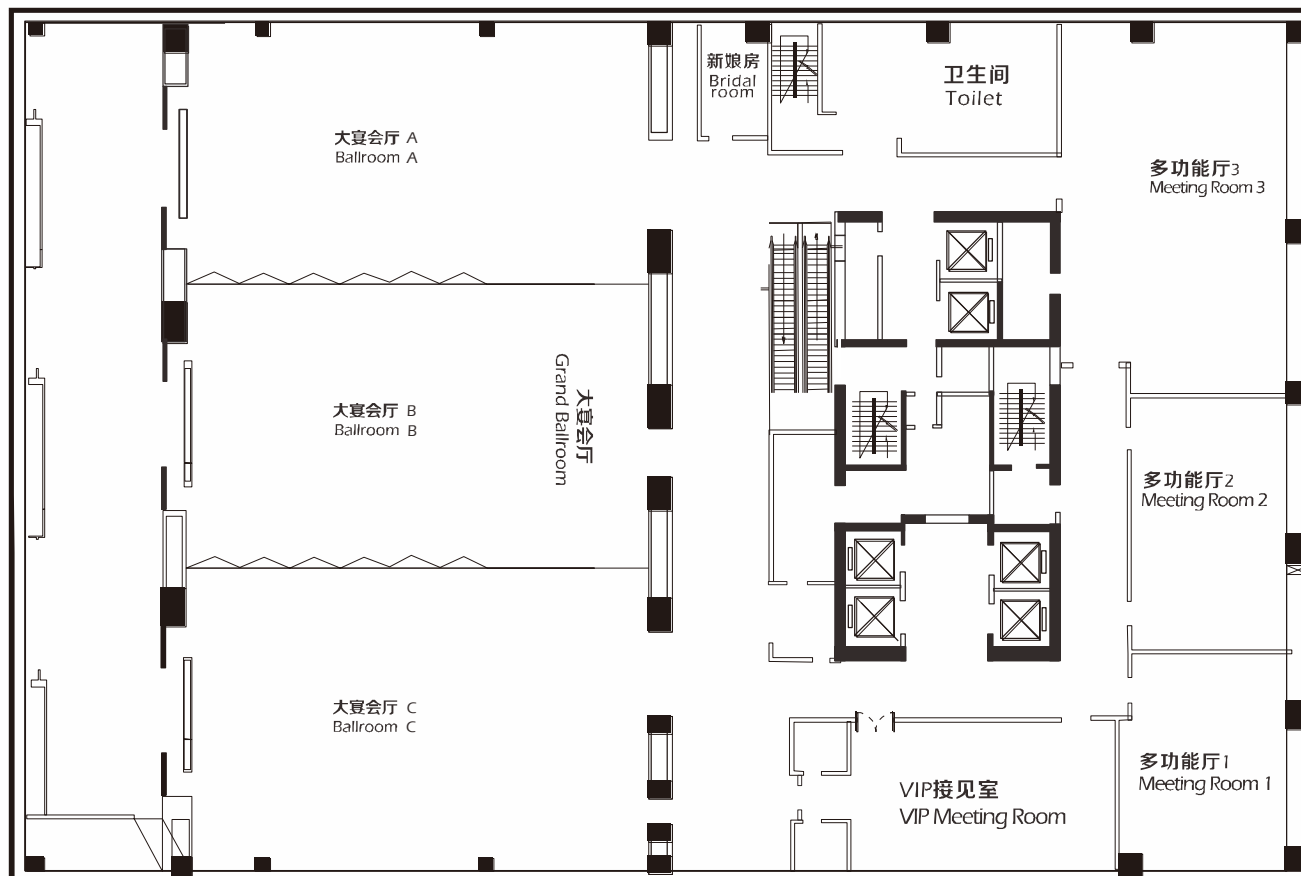

万达浪漫婚典 Wedding Ceremony



- 大宴会厅：容纳60桌
Grand Ballroom: 60 tables
- 大宴会厅 1+2/2+3：容纳30桌
Grand Ballroom 1+2/2+3: 30 tables
- 大宴会厅 1/2/3：容纳15桌
Grand Ballroom 1/2/3: 15 tables

您值得拥有一场完美的婚礼。安阳富力万达嘉华酒店将以享负盛名的“万达浪漫婚典”服务为您打造一场美轮美奂的大婚庆典。专业的活动策划团队将倾力助阵，为您提供一站式服务，力求婚礼每个细节的尽善尽美。

You deserve the very best on your wedding day. For a magical celebration, Wanda Realm Anyang is at your service with the support of our signature “Wanda Romance Wedding Ceremony” service. Bring you the support of a dedicated team of event planners, this one-stop service ensures that every detail on your big day is truly taken care of.



健身中心 Health Club



游泳池营业时间 Swimming pool opening time: 06:00-23:00

健身房营业时间 Gym business hours: 24 Hours

预订电话 Tel: 0372-377 9999

酒店配备了世界一流水准的健身与休闲设施，包括室内恒温游泳池、设备齐全的健身房、跳操房、桑拿房、蒸气房、按摩浴缸及美发沙龙等，为宾客们在繁忙都市生活中打造最惬意的身心放松体验。

After a busy day of meetings or sightseeing, soothe your mind and body with the five-star leisure facilities of Wanda Realm Anyang. These superb facilities include an indoor heated swimming pool, a fully-equipped gym, aerobics room, Sauna, steam room, whirlpool bath and hair salon.



地理位置 Location



安阳富力万达嘉华酒店地处安阳核心区域，毗邻安阳万达广场，附近拥有高端商务写字楼、服务式豪华公寓、超大购物中心及电影院，为本地及来自世界各地的商旅客人提供便捷的住宿和娱乐体验。酒店距离安阳高铁站仅15分钟车程，前往河北邯郸机场亦只需50分钟车程，交通极为便利。独特的地理位置优势和精良的设施设备，无论是小型的董事会或是大型的论坛会议及宴会，无论您是旅游度假，还是商务出差，安阳富力万达嘉华酒店都是您的不二之选。

Superbly situated in the city's dynamic Central Business District, adjacent to Wanda Plaza, the hotel is within walking distance of the top leisure and entertainment venues. Wanda Realm Anyang is just a 15-minute drive from the Anyang high-speed railway station and only 50 minutes from Hebei Handan Airport. Unique geographical location advantages and excellent facilities, whether small or board meeting and banquet, or a tourist resort, or traveling on business, Wanda Realm Anyang is your best choice!

中国河南省安阳市文峰区中华路南段29号安阳万达广场8-3号楼邮编: 455000

8-3# Building, Anyang Wanda Plaza, NO.29
Zhonghua Road South Wenfeng District,
Anyang, Henan Province 455000, P.R.China



WANDA REALM

Anyang

安阳富力万达嘉华酒店

Welcome



酒店官方微信



酒店官方微博

中国河南省安阳市文峰区中华路南段29号安阳万达广场8-3号楼 邮编: 455000
8-3# Building, Anyang Wanda Plaza, NO.29 Zhonghua Road South Wenfeng District, Anyang,
Henan Province 455000, P.R.China
电话Tel: (86 0372) 377 9999 传真Fax: (86 0372) 377 9996
www.wandahotels.com