



WANDA REALM

Kunming

昆明呈贡万达嘉华酒店



昆明呈贡万达嘉华酒店介绍

Wanda Realm Kunming Introduction



WANDA REALM

Kunming

昆明呈贡万达嘉华酒店

知所需 心安为嘉

A Reward You Deserve

万达嘉华是万达酒店及度假村旗下的高端酒店，为商务旅行及休闲度假宾客，提供品质出众、高效舒适的国际化服务，并予以安心入住体验的高端酒店品牌。

Wanda Realm is a premium hotel brand under Wanda Hotels and Resorts, providing high quality, efficient and comfortable international services for business travelers and leisure guests with a deserved stay experience.



酒店概况

Hotel Introduction



WANDA REALM
Kunming
昆明呈贡万达嘉华酒店

酒店拥有302间宽敞舒适的客房及套房，设计高雅、配套豪华。餐饮设施齐全，“美食汇”全日餐厅、“品珍”中餐厅，以及大堂酒廊，为您奉上精美的环宇美饌定让您大快朵颐。

酒店的宴会及会议总接待面积近1,700平方米，豪华无柱式大宴会厅面积为900平方米，是举办成功会议、浪漫婚典、高端酒会的优选酒店。

The hotel has 302 guest rooms and suites with elegant design and luxurious facilities. The dining facilities are "Realm Cafe" All-Day Dinning Restaurant, "Zhen" Chinese Restaurant, and Lobby Lounge, providing various and exquisite dishes for options.

It has a nearly 1,700 square meters for banquets and conferences including reception area, and the ballroom is with luxurious column-free with 900 square meters. It is the preferred hotel for hosting conferences, romantic weddings and high-end cocktail parties.



位置

Hotel Location



WANDA REALM
Kunming
昆明呈贡万达嘉华酒店

昆明呈贡万达嘉华酒店是由昆明发展投资集团有限公司投资建设，万达酒店及度假村运营管理的酒店。酒店位于云南省昆明市呈贡区，交通便利，配套齐全，毗邻呈贡万达广场、春城公园和昆明宪法主题公园，靠近昆明市政府政务服务中心，距离昆明长水国际机场约40分钟车程，距离昆明南站约15分钟车程。

Wanda Realm Kunming is invested by Kunming Development Investment Group Co., LTD and managed by Wanda Hotels & Resorts. It is located in Chenggong District, Kunming City, Yunnan Province, with convenient transportation and various supporting facilities, adjoining to Chenggong Wanda Shopping Mall, Spring City Park and Kunming Constitution Theme Park. The Kunming Municipal Government Service Center is also nearly to the hotel. It's about 40 minutes' drive to Kunming Chang shui International Airport, and about 15 minutes' drive to Kunming High-speed Railway Station.



交通 Transportation



WANDA REALM
Kunming
昆明呈贡万达嘉华酒店



长水国际机场

Chang shui International Airport

- 通行城市达170+，其中国际地区通行城市51个，是国内连接南亚、东南亚通航点最多的机场。
- 2021年旅客吞吐量达3200万人次。
- There are 170+ navigable cities, of which 51 are foreign cities. it is the domestic airport with the most traffic points connecting South Asia and Southeast Asia.
- In 2021, the annual passenger throughput reaches 32 million.



高铁南站

High-speed Rail Station

- 京昆、沪昆、渝昆、汕昆、广昆、杭瑞、银昆国家高速公路四通八达，12条地方高速通达全省各地。
- 昆曼国际高速公路，全长1800余公里，途径老挝境内，是中国第一条国际高速公路。
- National highways can lead to Beijing, Shanghai, Chongqing, Yinchuan etc. Also 12 highways reaches all over the province.
- Kunming-Bangkok highway, total length over 1800kms and though Laos, which is the first international highway in China.



高速公路

Highway

- 便利通达北上广深、华东、华中、华南区域，贯通大理、丽江、西安、香港等地区。
- 地处泛亚铁路交点，正在建设国际线路。
- Kunming high-speed way can reach most parts of China, such as Beijing, Shanghai, Guangzhou Shenzhen, East China, Central China, South China. It has connected Dali, Lijiang, Xi'an, Hongkong etc.
- Located at the Trans-Asian Railway Line, international lines are being built .

客房
Rooms



房型 Room Type	数量 No.of Rooms	大床 King Bed	双床 Twin Bed	面积(平方米) Area/m ²
豪华房 Deluxe Room	111	36	75	46
好莱坞房 Hollywood Room	24	/	24	46
无障碍客房 Handicapped Deluxe King Room	2	2	/	46
高级豪华房 Grand Deluxe King	87	51	36	46
行政楼层豪华房 Executive Floor Deluxe King	58	39	19	46
豪华套房 Deluxe Suite	18	18	/	92
行政套房 Executive Suite	1	1	/	138
总统套房 Presidential Suite	1	1	/	176
合计 Total	302	148	154	/

客房 Rooms



WANDA REALM
Kunming
昆明呈贡万达嘉华酒店



豪华大床房
Deluxe King

豪华双床房
Deluxe Twin



客房 Rooms



WANDA REALM
Kunming
昆明呈贡万达嘉华酒店

豪华套房 Deluxe Suite



行政豪华房 Executive Deluxe Room



总统套房 Presidential Suite



大堂酒廊 Lobby Lounge



WANDA REALM
Kunming
昆明呈贡万达嘉华酒店

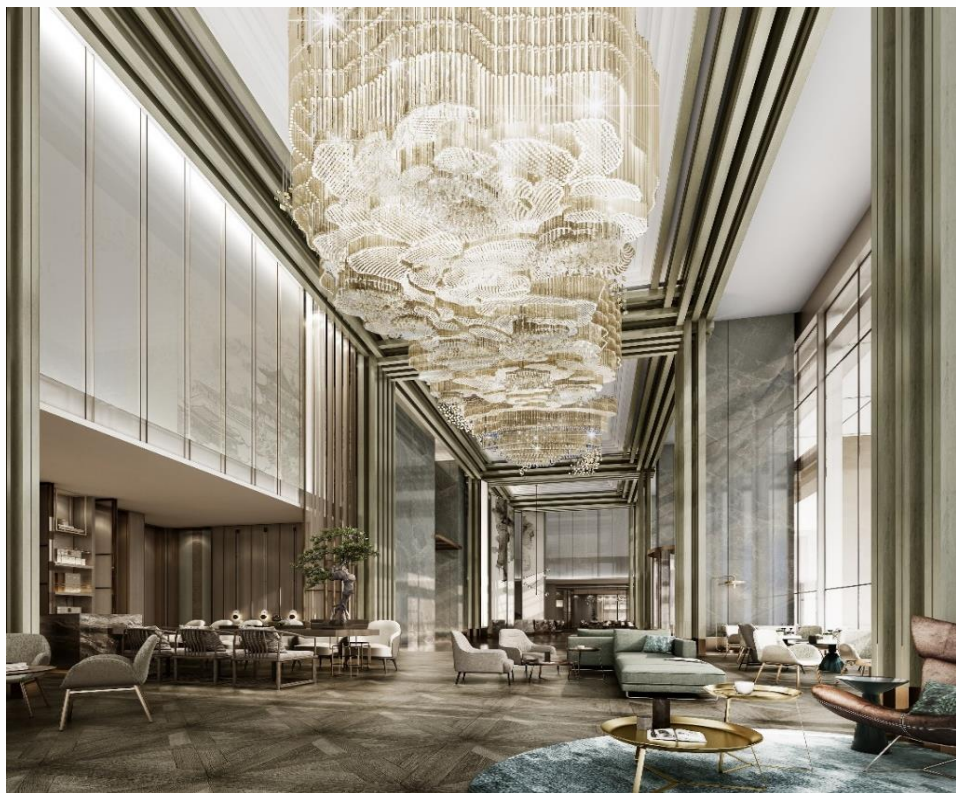

LOBBY LOUNGE 大堂酒廊

大堂酒廊，装潢雅致，书香墨语，在此品酒饮茶享受惬意舒适的休闲时光。

Lobby lounge, elegant decoration, bookish ink language, in this wine tasting tea to enjoy comfortable leisure time.

地点/Venue: 酒店一楼 1F

营业时间 / Business Hours: 08:30- 23:00

座位/ Capacity: 35

嘉华行政酒廊 Executive Lounge



WANDA REALM
Kunming
昆明呈贡万达嘉华酒店



EXECUTIVE LOUNGE

嘉华行政酒廊

嘉华行政酒廊，环境清雅，居高临下，在此可尊享酒店提供的高品质个性化服务。

The Executive Lounge locates on the top floor of the hotel with a high and far view.

The elegant environment is a fine choice for high quality personalized service.

地点/Venue: 酒店三十八楼 38F

营业时间 / Business Hours: 06:30- 23:00

座位/ Capacity: 63

品珍中餐厅

ZHEN Chinese Restaurant



WANDA REALM
Kunming
昆明呈贡万达嘉华酒店

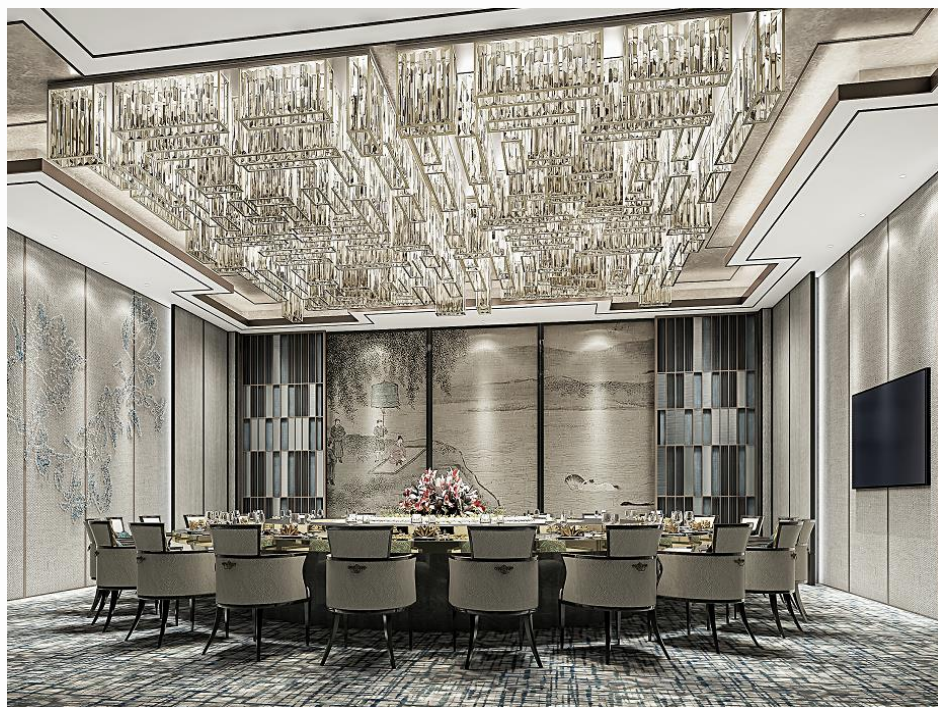

“品珍”中餐厅主营滇川菜为主，粤菜为辅，专注于原汁原味以及均衡营养，拥有7个独立包间和1个散座大厅。

"Zhen" Chinese restaurant mainly serves Yunnan-Sichuan cuisine, supplemented by Cantonese cuisine. It focuses on original flavor and balanced nutrition. It has 7 independent private rooms and 1 public dining area.

地点/Venue: 酒店二楼 2F

营业时间 / Business Hours: : 11:30-14:00 | 17:30-22:00

座位/ Capacity: 100

美食汇全日餐厅

Café Realm



WANDA REALM
Kunming
昆明呈贡万达嘉华酒店



明净雅致的美食汇全日餐厅，汇聚全球各国美食，提供上百种精选美味，饕餮自助和招牌零点让食客大快朵颐。

Café Realm, brings together cuisines from all over the world, offering hundreds of selected delicacies, gluttonous buffet and signature a la carte dishes for diners to enjoy.

地点/Venue: 酒店一楼 1F

营业时间 / Business Hours: : 06:30-10:30 | 11:00-14:00 | 17:30-21:30

座位/ Capacity: 178

会议与宴会

Meeting & Banquet



WANDA REALM
Kunming
昆明呈贡万达嘉华酒店

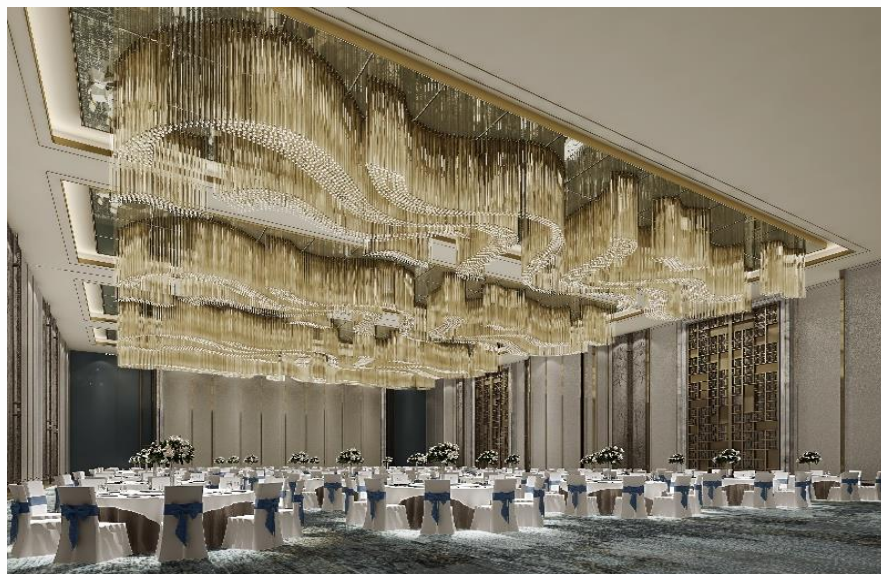

会议总接待面积1700平方米，5间多功能厅设计华丽而精致。面积约900平方米的无柱大宴会厅，同时配备60平方米的上墙LED屏，配备先进会议活动设施及专业体贴的会议管家服务。

The total reception area of the conference is 1700 square meters, with 5 multi-function rooms, which are beautifully designed and exquisite. The column-free ballroom covers an area of 900 square meters, equipped with LED screens about 60 square meters. It is equipped with advanced conference facilities with professional and considerate meeting butler service.











会议与宴会

Meeting & Banquet



WANDA REALM
Kunming
昆明呈贡万达嘉华酒店

容纳人数 Capacity

场地 Venue	 剧院式 Theatre	 课桌式 Classroom	 鸡尾酒会式 Cocktail	 U型 U-shape	 宴会式 Banquet	 口字形 Hollow Sq	 鱼骨 Fishbone	 会见 Interview	 面积 (平方米) Area (m ²)	 尺寸 (米) Dimensions (m)	 楼层高度 (米) Ceiling Height (m)
大宴会厅 Grand Ballroom	780	510	700	175	500	180	250	40	900	28*32	8
宴会厅 1 Ballroom 1	340	150	250	96	180	90	125	20	350	25*14	8
宴会厅 2 Ballroom 2	340	150	250	96	180	90	125	20	350	25*14	8
宴会前厅 Ballroom Foyer	-	-	150	-	80	-	-	-	200	20*10	8
宴会厅 1+2 Ballroom 1+2	680	390	500	175	420	180	250	40	700	28*25	8
宴会厅 1+前厅 Ballroom 1+Foyer	440	200	300	120	240	115	165	20	448	32*14	8
多功能厅 1 Function Room 1	70	36	50	45	40	48	42	12	80	10*8	3
多功能厅 2 Function Room 2	80	45	60	54	50	60	56	14	100	12.5*8	3
多功能厅 5 Function Room 5	48	24	40	27	40	30	42	12	66	11*6	3
多功能厅 6 Function Room 6	40	18	30	24	30	27	28	8	60	10*6	3
多功能厅 5+6 Function Room 5+6	100	54	80	48	80	54	84	20	126	21*6	3
多功能厅 7 Function Room 7	40	36	40	30	40	36	42	12	64	8*8	3
海晏厅 HAIYAN	-	-	-	-	-	-	-	-	36	8*4.5	3
碧潭厅 BITAN	-	-	-	-	-	-	-	10	50	8.5*6	3

健身中心及泳池

Health Center & Swimming Pool



WANDA REALM
Kunming
昆明呈贡万达嘉华酒店

酒店健身中心设施完备，能同时满足您的各种健身需求。健身房配备国际先进健身设备，300平方米游泳池视野广阔，一览无余，恒温泳池28度，另配备干蒸房、儿童活动室、乒乓球室、台球室，一并满足多元化健身和亲子健身。

The Fitness center could reach all kinds of fitness needs with complete faculties. The gym is equipped with the most advanced international fitness equipment. The swimming pool has a wide view with 300-square-meter and a constant temperature of 28 degrees. Besides, it is also equipped with a dry steam room, children's activity room, table tennis room and billiard room, which can meet the needs of diversified fitness and parent-child fitness.



地点/Venue: 酒店五楼 5F

营业时间 / Business Hours: 24小时

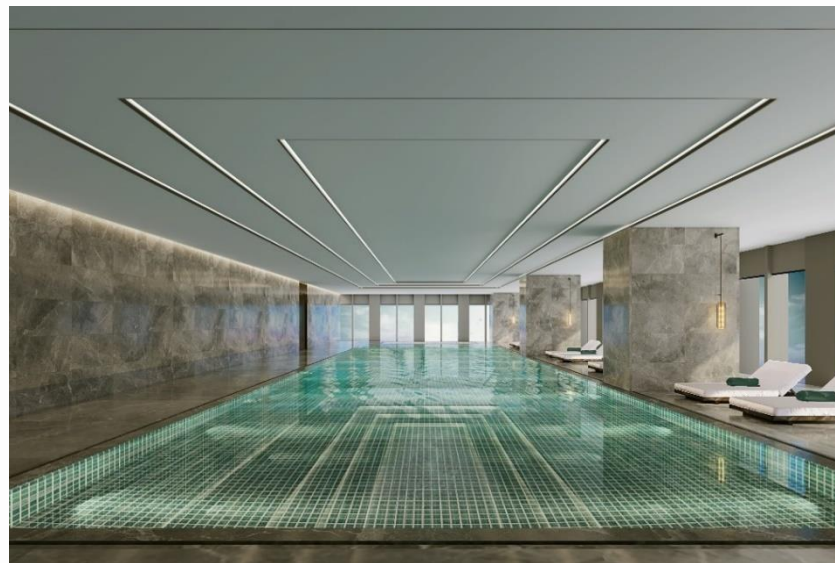

地点/Venue: 酒店五楼 5F

营业时间 / Business Hours: 06:00- 23:00

昆明
Kunming



WANDA REALM
Kunming
昆明呈贡万达嘉华酒店



昆明滇池国家旅游度假区

昆明滇池国家旅游度假区，是全国十二个国家级旅游度假区之一，也是全国十二个国家级旅游度假区中唯一位于内陆省的旅游度假区。全区规划控制面积18.06平方公里，南濒滇池，北连市区，东与西山区接壤，西与著名的西山森林公园隔湖相望。

距离：26公里； 驾车：45分钟

Kunming Dian chi National Tourism Resort is one of the 12 national tourism resorts and the only one located in the inland province. The planned control area of the district is 18.06 square kilometers, bordering Dian chi Lake in the south, urban areas in the north, mountainous areas in the east and the famous Xi Shan Forest Park across the lake in the west.

Distance: 26 km; Drive: 45 minutes.

玩在昆明

Play in Kunming



WANDA REALM
Kunming
昆明呈贡万达嘉华酒店



昆明斗南花卉市场
Dou nan Flower Market



七彩云南·古滇名城
Ancient Dian Wetland Park

西山森林公园
Xishan Forest Park



大观楼
Daguanlou Park



阳宗海
Yangzonghai Lake



石林风景区
Stone Forest Scenic Zone

吃在昆明

Food of Kunming



WANDA REALM
Kunming
昆明呈贡万达嘉华酒店



米线
Rice Noodle



云南野生菌
Wild Fungus

鲜花饼
Flower cake



云腿
Yunnan Ham



汽锅鸡
Steam Pot Chicken



普洱茶
Pu er tea



WANDA REALM

Kunming

昆明呈贡万达嘉华酒店



恭候君临
WELCOME

中国云南省昆明市呈贡区乌龙街道彩云南路1666号 邮政编码: 650500

#1666 South of Caiyun Road, Wulong Street, Chenggong District, Kunming, Yunnan Province 650500, P.R. China

电话Tel: (0871) 65912888 传真Fax: (0871) 65913166

www.wandahotels.com